

# PBA Pratt Burnerd 4-Jaw Independent Chucks

## Medium Duty-144 Series Heavy Duty-145 Series

- ☒ Two-year warranty
- ☒ Precision manufactured to fit types A, D, L, and threaded spindles or adapter mounting
- ☒ Ductile iron body
- ☒ Sizes 6" - 16"
- ☒ Hardened operating screws
- ☒ Solid reversible hard jaws
- ☒ Special jaw and jaw way design adding extra bearing surfaces, increases chuck life and rigidity

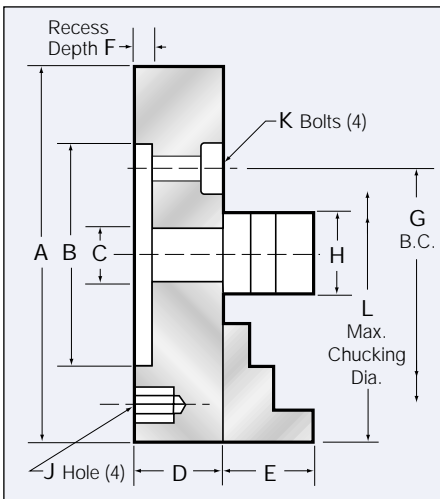

Chuck Size	Adapter Mounting Model No.	Type A Spindle Short Taper		Type D Spindle Camlock		Type L Spindle Long Taper	
		Size	Model No.	Size	Model No.	Size	Model No.
6	0614400	-	-	D-3	0614420	L-00	0614431
6	-	-	-	D-4	0614421	L-0	0614433
8	0814400	A-5	0814410	D-3	0814420	L-00	0814431
8	-	-	-	D-4	0814421	L-0	0814432
8	-	-	-	-	-	L-1	0814433
10	1014400	A-5	1014410	D-4	1014421	L-00	1014431
10	-	-	-	D-5	1014422	-	-
10	-	A-6	1014411	D-6	1014423	L-0	1014432
10	-	A-8	1014412	D-8	1014424	L-1	1014433
12	1214400	A-6	1214411	D-6	1214423	L-0	1214432
12	-	A-8	1214412	D-8	1214424	L-1	1214433
14	1414500	A-6	1414511	D-6	1414523	L-1	1414533
14	-	A-8	1414512	D-8	1414524	L-2	1414534
16	1614500	A-8	1614512	D-8	1614524	L-1	1614533
16	-	A-11	1614513	D-11	1614525	L-2	1614534

Larger diameter chucks available, contact us for price and delivery.

### Dimensional Data for Adapter Mounting Chucks

Chuck Size	A	B	C	D	E	F	G	H	J	K	L	Gripping Capacity		Lbs Wt.
												Min.	Max.	
6	6.30	4.921	1.77	2.12	.87	.16	5.512	.94	M10	M10	7 <sup>1</sup> / <sub>8</sub>	5/16	5	16
8	7.87	4.921	1.97	2.83	1.22	.16	5.512	1.26	M10	M10	9 <sup>1</sup> / <sub>4</sub>	5/16	7	31
10	9.84	7.874	2.36	2.83	1.22	.19	8.819	1.26	M12	M12	12	1/2	8	43
12	12.40	7.874	2.95	3.15	1.42	.19	8.819	1.42	M12	M12	14	1/2	10	72
14	13.80	10.236	2.95	3.58	1.47	.19	11.26	1.42	-	M12	16	3/4	12	126
16	15.75	10.236	2.95	3.58	1.47	.19	11.26	1.42	-	M12	18	3/4	14	180

HOW TO ORDER: State quantity, Model Number of chuck, Part Number of adapter, and shipping instructions.

# Pratt Burnerd Mounting Plates

## 144 and 145 Series Independent Chucks

Mounting plates are precision machined to suit the spindle nose of your machine. Plates are stocked semi-finished. If ordering plate separately, specify the model number of your chuck so that PBA can finish machine the adapter to suit your Pratt Burnerd chuck.

### Type D Camlock Mountings

Spindle	6"	8"	10"	12"	14"	16"
D-3	0603020	0603020	1003020	1003020	-	-
D-4	0603021	0603021	1003021	1003021	-	-
D-5	0603022	0603022	1003022	1003022	1203022	-
D-6	-	0603023	1003023	1003023	1203023	1203023
D-8	-	-	1003024	1003024	1203024	1203024
D-11	-	-	-	-	1203025	1203025

### Type A American Standard Short Taper A1 & A2 Spindles

Spindle	6"	8"	10"	12"	14"	16"
A-5	0603010	0603010	1003010	-	-	-
A-6	0603011	0603011	1003011	1003011	-	-
A-8	-	-	1003012	1003012	1203012	1203012
A-11	-	-	-	-	1203013	1203013

### Type L American Standard Long Taper Spindles

Spindle	6"	8"	10"	12"	14"	16"
L-00	0603031	0603031	1003031	-	-	-
L-0	0603032	0603032	1003032	1003032	1203032	-
L-1	-	-	1003033	1003033	1203033	1203033
L-2	-	-	1003034	1003034	1203034	1203034

### Threaded Spindles

Spindle	6"	8"	10"
1½"-8	0603041	0603041	-
1¾"-8	0603042	0603042	-
2¼"-8	0603043	0603043	1003043

### Hardinge 4° Taper Plate

Spindle	6"	8"
4° Taper	0604044	0604044

Special adapter plates available upon request. Specify chuck number and spindle nose specifications. 6", 8", 10" and 12" adapters are the same as 3 Jaw adapters on page 10. For standard spindle dimensions, see page 96.