

HYDRAULIC CHUCKS



CUSTOM TOOLS

PRESETTERS

END MILL HOLDERS

SHELL MILL HOLDERS

MILLING CHUCKS

COLLET CHUCKS

HYDRAULIC CHUCKS

DRILL CHUCKS

TAP HOLDERS





HYDRAULIC CHUCKS ARE THE MOST ACCURATE TOOLHOLDERS EVER DEvised.

Unlike conventional toolholders that utilize a hardened static I.D. bore, hydraulic chucks employ a flexible metal membrane to envelope tool shanks. When loaded, pressurized hydraulic fluid uniformly expands the thin membrane against the tool shank's surface, gripping it tightly. The extreme concentricity of the gripping action enables the flexible membrane to compensate for any tool shank imperfections, maximizing the cutting tool's accuracy.

Lyndex Hydraulic Chucks are designed to reduce set-up times, and ideal for double spindle machines, transfer lines, and multi-spindle heads where an exact length adjustment is absolutely essential. The length adjustment feature allows tools to be axially adjusted with ease speed and precision.

Lyndex Hydraulic Chucks are designed around self-contained immediate-response hydraulic reservoirs and patented triple-grip membrane sleeves. These reservoirs and sleeves provide perfect sealing for coolant-thru applications.

Slide a cutting tool into a Lyndex Hydraulic Chuck. Within 2 or 3 turns of an actuating screw that tool is secured by 8700 PSI of hydraulic muscle. Don't ever worry about overtightening and popping a seal, because the screw bottoms out at operating pressure.

The sleeves deliver guaranteed precision of 0.0003" TIR at 4" out. Their one-of-a-kind gripping action guarantees absolute tool rigidity for repeatable cuts every time. This triple-grip design counteracts the sleeve deformation inherent to single-grip sleeves used by other manufacturers - our sleeves maintain their tolerances!

Lyndex Hydraulic Chucks are manufactured from the finest steels and are perfectly heat treated. Each is given a special surface treatment to inhibit corrosion.

Every Lyndex Hydraulic Chuck must pass three tough accuracy tests, and each comes with a certificate to verify its own tested accuracy.

Note: HSK Taper Hydraulic Chucks are listed on pages 209-210.

HYDRAULIC CHUCKS

CT40 HYDRAULIC CHUCKS

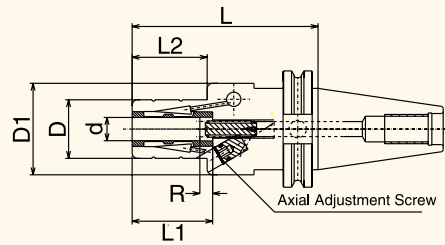

Part Number	Taper	d	L	L1	R	L2	D	D1
C40HH-0250	CT40	1/4"	3.50"	1.50"	0.39"	1.22"	1.02"	1.97"
C40HH-0375	CT40	3/8"	4.00"	1.65"	0.39"	1.38"	1.19"	1.97"
C40HH-0500	CT40	1/2"	4.00"	1.73"	0.39"	1.61"	1.26"	1.97"
C40HH-0625	CT40	5/8"	4.00"	1.85"	0.39"	1.81"	1.50"	1.97"
C40HH-0750	CT40	3/4"	4.00"	1.85"	0.39"	1.81"	1.50"	1.97"
C40HH-1000	CT40	1"	4.50"	2.40"	0.39"	2.13"	1.85"	2.17"

CT40 HYDRAULIC CHUCKS (METRIC)

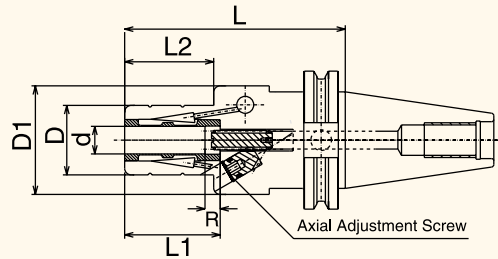

Part Number	Taper	d	L	L1	R	L2	D	D1
C40HH-6	CT40	6mm	89mm	38mm	10mm	30mm	26mm	50mm
C40HH-8	CT40	8mm	89mm	38mm	10mm	31mm	28mm	50mm
C40HH-10	CT40	10mm	89mm	42mm	10mm	35mm	30mm	50mm
C40HH-12	CT40	12mm	102mm	44mm	10mm	41mm	32mm	50mm
C40HH-16	CT40	16mm	102mm	47mm	10mm	46mm	38mm	50mm
C40HH-18	CT40	18mm	102mm	47mm	10mm	46mm	40mm	50mm
C40HH-20	CT40	20mm	102mm	47mm	10mm	52mm	42mm	50mm
C40HH-25	CT40	25mm	114mm	61mm	10mm	54mm	47mm	55mm

Note: All 40/50 Taper Hydraulic Chucks are pre-balanced to G2.5 at 15,000 RPM.

HYDRAULIC CHUCKS

CT50 HYDRAULIC CHUCKS

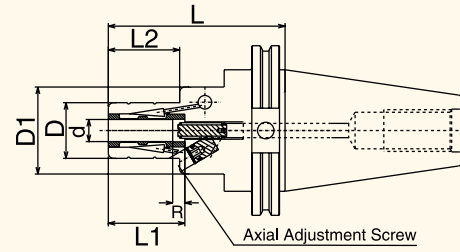

Part Number	Taper	d	L	L1	R	L2	D	D1
C50HH-0250	CT50	1/4"	4.00"	1.50"	0.39"	1.22"	1.02"	1.97"
C50HH-0375	CT50	3/8"	4.00"	1.65"	0.39"	1.38"	1.19"	1.97"
C50HH-0500	CT50	1/2"	4.00"	1.73"	0.39"	1.61"	1.26"	1.97"
C50HH-0625	CT50	5/8"	4.00"	1.85"	0.39"	1.81"	1.50"	1.97"
C50HH-0750	CT50	3/4"	4.00"	1.85"	0.39"	1.81"	1.50"	1.97"
C50HH-1000	CT50	1"	4.00"	2.40"	0.39"	2.13"	1.85"	2.75"
C50HH-1250	CT50	1-1/4"	4.00"	2.56"	0.39"	2.13"	2.13"	2.75"

CT50 HYDRAULIC CHUCKS (METRIC)

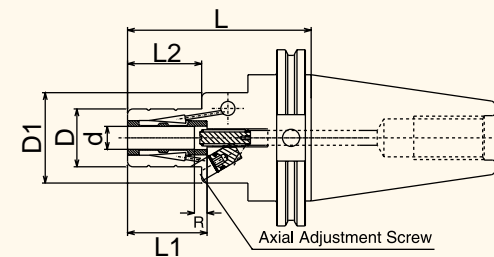

Part Number	Taper	d	L	L1	R	L2	D	D1
C50HH-6	CT50	6mm	102mm	38mm	10mm	31mm	26mm	50mm
C50HH-8	CT50	8mm	102mm	38mm	10mm	32mm	28mm	50mm
C50HH-10	CT50	10mm	102mm	42mm	10mm	35mm	30mm	50mm
C50HH-12	CT50	12mm	102mm	44mm	10mm	41mm	32mm	50mm
C50HH-16	CT50	16mm	102mm	47mm	10mm	46mm	38mm	50mm
C50HH-18	CT50	18mm	102mm	47mm	10mm	46mm	40mm	50mm
C50HH-20	CT50	20mm	102mm	50mm	10mm	52mm	42mm	50mm
C50HH-25	CT50	25mm	102mm	54mm	10mm	54mm	47mm	70mm
C50HH-32	CT50	32mm	102mm	62mm	10mm	54mm	54mm	70mm

Note: HSK Taper Hydraulic Chucks are listed on pages 209-210.

HYDRAULIC CHUCKS

BT40 HYDRAULIC CHUCKS

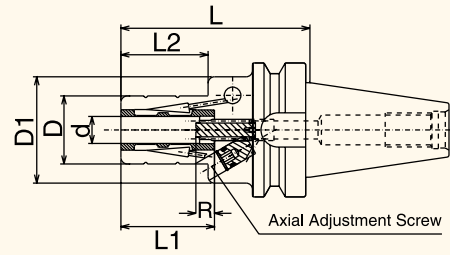

Part Number	Taper	d	L	L1	R	L2	D	D1
B40HH-0250	BT40	1/4"	3.50"	1.50"	0.39"	1.22"	1.02"	1.97"
B40HH-0375	BT40	3/8"	3.50"	1.65"	0.39"	1.38"	1.19"	1.97"
B40HH-0500	BT40	1/2"	3.50"	1.73"	0.39"	1.61"	1.26"	1.97"
B40HH-0625	BT40	5/8"	3.50"	1.85"	0.39"	1.81"	1.50"	1.97"
B40HH-0750	BT40	3/4"	3.50"	1.85"	0.39"	1.81"	1.50"	1.97"
B40HH-1000	BT40	1"	4.50"	2.40"	0.39"	2.13"	1.85"	2.17"

BT40 HYDRAULIC CHUCKS (METRIC)

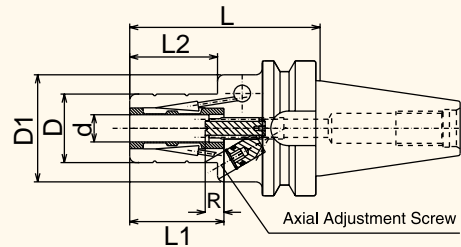

Part Number	Taper	d	L	L1	R	L2	D	D1
B40HH-6	BT40	6mm	89mm	38mm	10mm	31mm	26mm	50mm
B40HH-8	BT40	8mm	89mm	38mm	10mm	32mm	28mm	50mm
B40HH-10	BT40	10mm	89mm	42mm	10mm	35mm	30mm	50mm
B40HH-12	BT40	12mm	89mm	44mm	10mm	41mm	32mm	50mm
B40HH-16	BT40	16mm	89mm	47mm	10mm	46mm	38mm	50mm
B40HH-18	BT40	18mm	89mm	47mm	10mm	46mm	40mm	50mm
B40HH-20	BT40	20mm	89mm	50mm	10mm	52mm	42mm	50mm
B40HH-25	BT40	25mm	102mm	61mm	10mm	54mm	47mm	55mm

Note: All 40/50 Taper Hydraulic Chucks are pre-balanced to G2.5 at 15,000 RPM.



CUSTOM TOOLS
PRESETTERS
END MILL HOLDERS
SHELL MILL HOLDERS
MILLING CHUCKS
COLLET CHUCKS
HYDRAULIC CHUCKS
DRILL CHUCKS
TAP HOLDERS

HYDRAULIC CHUCKS

BT50 HYDRAULIC CHUCKS

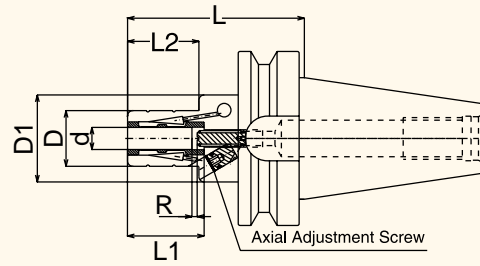

Part Number	Taper	d	L	L1	R	L2	D	D1
B50HH-0250	BT50	1/4"	4.00"	1.50"	0.39"	1.22"	1.02"	1.97"
B50HH-0375	BT50	3/8"	4.00"	1.65"	0.39"	1.38"	1.19"	1.97"
B50HH-0500	BT50	1/2"	4.00"	1.73"	0.39"	1.61"	1.26"	1.97"
B50HH-0625	BT50	5/8"	4.00"	1.85"	0.39"	1.81"	1.50"	1.97"
B50HH-0750	BT50	3/4"	4.00"	1.85"	0.39"	1.81"	1.50"	1.97"
B50HH-1000	BT50	1"	4.50"	2.40"	0.39"	2.13"	1.85"	2.17"
B50HH-1250	BT50	1-1/4"	4.75"	2.56"	0.39"	2.13"	2.14"	2.44"

BT50 HYDRAULIC CHUCKS (METRIC)

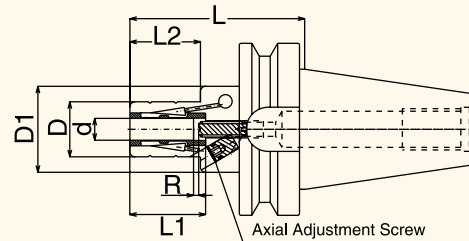

Part Number	Taper	d	L	L1	R	L2	D	D1
B50HH-6	BT50	6mm	102mm	38mm	10mm	31mm	26mm	50mm
B50HH-8	BT50	8mm	102mm	38mm	10mm	32mm	28mm	50mm
B50HH-10	BT50	10mm	102mm	42mm	10mm	35mm	30mm	50mm
B50HH-12	BT50	12mm	102mm	44mm	10mm	41mm	32mm	50mm
B50HH-16	BT50	16mm	102mm	47mm	10mm	46mm	38mm	50mm
B50HH-18	BT50	18mm	102mm	47mm	10mm	46mm	40mm	50mm
B50HH-20	BT50	20mm	102mm	50mm	10mm	52mm	42mm	50mm
B50HH-25	BT50	25mm	114mm	54mm	10mm	54mm	47mm	55mm
B50HH-32	BT50	32mm	121mm	65mm	10mm	54mm	54mm	62mm

Note: HSK Taper Hydraulic Chucks are listed on pages 209-210.