

END MILL HOLDERS



CUSTOM TOOLS

PRESETTERS

END MILL HOLDERS

SHELL MILL HOLDERS

MILLING CHUCKS

COLLET CHUCKS

HYDRAULIC CHUCKS

DRILL CHUCKS

TAP HOLDERS



END MILL HOLDERS

CT40 END MILL HOLDERS

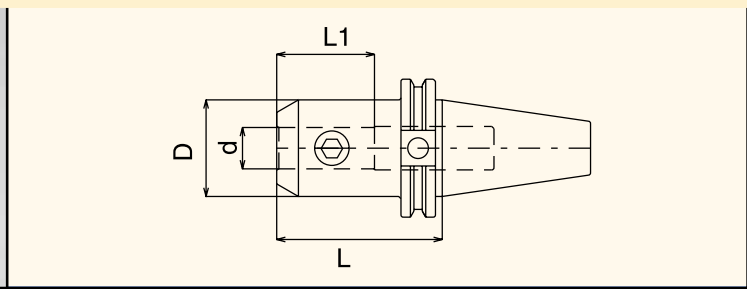

Part Number	Taper	d	L	L1	D	Set Screw
C40S6-0125	CT40	1/8"	1.38"	0.74"	0.75"	6-32X1/4
C4006-0125	CT40	1/8"	2.36"	0.63"	0.75"	6-32X1/4
C4016-0125	CT40	1/8"	4.00"	0.63"	0.75"	6-32X1/4
C40S6-0187	CT40	3/16"	1.38"	0.94"	0.75"	8-32X1/4
C4006-0187	CT40	3/16"	2.50"	0.86"	0.75"	8-32X1/4
C4016-0187	CT40	3/16"	4.00"	0.86"	0.75"	8-32X1/4
C40S6-0250	CT40	1/4"	1.38"	1.18"	0.79"	1/4-28X1/4
C4006-0250	CT40	1/4"	2.50"	1.10"	0.79"	1/4-28X1/4
C4016-0250	CT40	1/4"	4.00"	1.10"	0.79"	1/4-28X1/4
C40S6-0312	CT40	5/16"	1.38"	1.34"	0.87"	5/16-24X1/4
C4006-0312	CT40	5/16"	2.50"	1.26"	0.87"	5/16-24X1/4
C4016-0312	CT40	5/16"	4.00"	1.26"	0.87"	5/16-24X1/4
C40S6-0375	CT40	3/8"	1.38"	1.34"	1.00"	3/8-24X5/16
C4006-0375	CT40	3/8"	2.50"	1.26"	1.00"	3/8-24X5/16
C4016-0375	CT40	3/8"	4.00"	1.26"	1.00"	3/8-24X5/16
C4026-0375	CT40	3/8"	5.00"	1.26"	1.00"	3/8-24X5/16
C4006-0437	CT40	7/16"	2.50"	1.50"	1.38"	7/16-20X3/8
C4016-0437	CT40	7/16"	4.00"	1.50"	1.38"	7/16-20X3/8
C40S6-0500	CT40	1/2"	1.75"	1.50"	1.38"	7/16-20X3/8
C4006-0500	CT40	1/2"	2.50"	1.50"	1.38"	7/16-20X3/8
C4016-0500	CT40	1/2"	4.00"	1.50"	1.38"	7/16-20X3/8
C4026-0500	CT40	1/2"	5.00"	1.50"	1.38"	7/16-20X3/8
C40S6-0625	CT40	5/8"	1.75"	1.61"	1.65"	9/16-18X1/2
C4006-0625	CT40	5/8"	3.00"	1.61"	1.65"	9/16-18X1/2
C4016-0625	CT40	5/8"	4.00"	1.61"	1.65"	9/16-18X1/2
C4026-0625	CT40	5/8"	5.50"	1.61"	1.65"	9/16-18X1/2
C40S6-0750	CT40	3/4"	1.75"	1.77"	1.89"	5/8-18X1/2
C4006-0750	CT40	3/4"	3.00"	1.77"	1.75"	5/8-18X1/2
C4016-0750	CT40	3/4"	4.00"	1.77"	1.75"	5/8-18X1/2
C4026-0750	CT40	3/4"	5.50"	1.77"	1.75"	5/8-18X1/2
C40S6-0875	CT40	7/8"	1.75"	2.08"	1.94"	5/8-18X1/2
C4006-0875	CT40	7/8"	3.50"	2.08"	2.00"	5/8-18X1/2 (2)
C4016-0875	CT40	7/8"	6.00"	2.08"	2.00"	5/8-18X1/2 (2)

Note: End Mill Holders come equipped with set screws.

HSBALANCE™ End Mill Holders

For high speed applications, refer to the HSBALANCE™ section starting on page 221 for complete details.



END MILL HOLDERS

CT40 END MILL HOLDERS (cont.)

Part Number	Taper	d	L	L1	D	Set Screw
C40S6-1000	CT40	1"	2.00"	2.36"	2.25"	3/4-16X11/16
C4006-1000	CT40	1"	4.00"	2.36"	2.36"	3/4-16X11/16 (2)
C4016-1000	CT40	1"	6.00"	2.36"	2.36"	3/4-16X11/16 (2)
C40S6-1250	CT40	1-1/4"	2.00"	2.28"	2.25"	3/4-16X11/16
C4006-1250	CT40	1-1/4"	4.00"	2.55"	2.48"	3/4-16X11/16 (2)
C4016-1250	CT40	1-1/4"	6.00"	2.55"	2.48"	3/4-16X11/16 (2)
C4006-1500	CT40	1-1/2"	4.50"	2.55"	2.99"	3/4-16X11/16 (2)
C4016-1500	CT40	1-1/2"	6.00"	2.83"	2.99"	3/4-16X11/16 (2)

CT40 END MILL HOLDERS (METRIC)

Part Number	Taper	d	L	L1	D	Set Screw
C4006-6	CT40	6mm	2.50"	1.10"	0.78"	1/4-28X1/4
C4006-8	CT40	8mm	2.50"	1.25"	0.87"	5/16-24X1/4
C4006-10	CT40	10mm	2.50"	1.25"	1.00"	3/8-24X5/16
C4006-12	CT40	12mm	2.50"	1.50"	1.38"	7/16-20X3/8
C4006-14	CT40	14mm	3.00"	1.61"	1.65"	9/16-18X1/2
C4006-16	CT40	16mm	3.00"	1.61"	1.65"	9/16-18X1/2
C4006-18	CT40	18mm	3.00"	1.77"	1.75"	5/8-18x1/2
C4006-20	CT40	20mm	3.00"	1.77"	1.75"	5/8-18x1/2
C4006-25	CT40	25mm	4.00"	2.36"	2.36"	3/4-16X11/16 (2)
C4006-32	CT40	32mm	4.00"	2.36"	2.48"	3/4-16X11/16 (2)

Note: End Mill Holders come equipped with set screws.



END MILL HOLDERS

CT40 END MILL HOLDERS - DIN

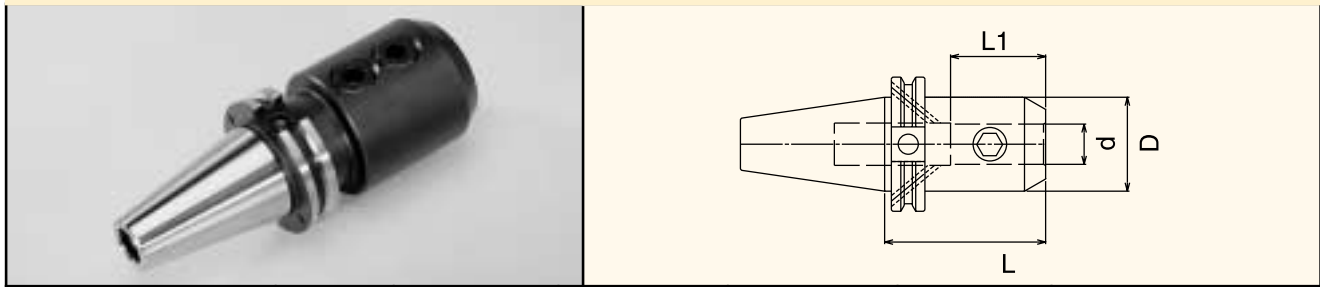

Part Number	Taper	d	L	L1	D	Set Screw
C4006-0125DIN	CT40	1/8"	2.36"	0.63"	0.75"	6-32X1/4
C4016-0125DIN	CT40	1/8"	4.00"	0.63"	0.75"	6-32X1/4
C4006-0187DIN	CT40	3/16"	2.50"	0.86"	0.75"	8-32X1/4
C4016-0187DIN	CT40	3/16"	4.00"	0.86"	0.75"	8-32X1/4
C4006-0250DIN	CT40	1/4"	2.50"	1.10"	0.79"	1/4-28X1/4
C4016-0250DIN	CT40	1/4"	4.00"	1.10"	0.79"	1/4-28X1/4
C4006-0312DIN	CT40	5/16"	2.50"	1.26"	0.87"	5/16-24X1/4
C4016-0312DIN	CT40	5/16"	4.00"	1.26"	0.87"	5/16-24X1/4
C4006-0375DIN	CT40	3/8"	2.50"	1.26"	1.00"	3/8-24X5/16
C4016-0375DIN	CT40	3/8"	4.00"	1.26"	1.00"	3/8-24X5/16
C4006-0437DIN	CT40	7/16"	2.50"	1.50"	1.38"	7/16-20X3/8
C4016-0437DIN	CT40	7/16"	4.00"	1.50"	1.38"	7/16-20X3/8
C4006-0500DIN	CT40	1/2"	2.50"	1.50"	1.38"	7/16-20X3/8
C4016-0500DIN	CT40	1/2"	4.00"	1.50"	1.38"	7/16-20X3/8
C4006-0625DIN	CT40	5/8"	3.00"	1.61"	1.65"	9/16-18X1/2
C4016-0625DIN	CT40	5/8"	4.50"	1.61"	1.65"	9/16-18X1/2
C4006-0750DIN	CT40	3/4"	3.00"	1.77"	1.75"	5/8-18X1/2
C4016-0750DIN	CT40	3/4"	4.50"	1.77"	1.75"	5/8-18X1/2
C4006-0875DIN	CT40	7/8"	3.50"	2.08"	2.00"	5/8-18X1/2 (2)
C4016-0875DIN	CT40	7/8"	5.00"	2.08"	2.00"	5/8-18X1/2 (2)
C4006-1000DIN	CT40	1"	4.00"	2.36"	2.36"	3/4-16X11/16 (2)
C4016-1000DIN	CT40	1"	5.50"	2.36"	2.36"	3/4-16X11/16 (2)
C4006-1250DIN	CT40	1-1/4"	4.00"	2.55"	2.48"	3/4-16X11/16 (2)
C4016-1250DIN	CT40	1-1/4"	5.50"	2.55"	2.48"	3/4-16X11/16 (2)
C4006-1500DIN	CT40	1-1/2"	4.50"	2.60"	2.99"	3/4-16X11/16 (2)
C4016-1500DIN	CT40	1-1/2"	6.00"	2.60"	2.99"	3/4-16X11/16 (2)

HSBALANCE™ End Mill Holders

For high speed applications, refer to the HSBALANCE™ section starting on page 221 for complete details.



END MILL HOLDERS

CT40 END MILL HOLDERS (METRIC) - DIN

Part Number	Taper	d	L	L1	D	Set Screw
C4006-6DIN	CT40	6mm	2.50"	1.10"	0.78"	1/4-28X1/4
C4006-8DIN	CT40	8mm	2.50"	1.25"	0.87"	5/16-24X1/4
C4006-10DIN	CT40	10mm	2.50"	1.25"	1.00"	3/8-24X5/16
C4006-12DIN	CT40	12mm	2.50"	1.50"	1.38"	7/16-20X3/8
C4006-14DIN	CT40	14mm	3.00"	1.61"	1.65"	9/16-18X1/2
C4006-16DIN	CT40	16mm	3.00"	1.61"	1.65"	9/16-18X1/2
C4006-18DIN	CT40	18mm	3.00"	1.77"	1.75"	5/8-18x1/2
C4006-20DIN	CT40	20mm	3.00"	1.77"	1.75"	5/8-18x1/2
C4006-25DIN	CT40	25mm	4.00"	2.36"	2.36"	3/4-16X11/16 (2)
C4006-32DIN	CT40	32mm	4.00"	2.36"	2.48"	3/4-16X11/16 (2)

Note: "DIN" designates suitability for coolant through the flange per DIN 69871 Form B specs.

CT45 END MILL HOLDERS

Part Number	Taper	d	L	L1	D	Set Screw
C4506-0125	CT45	1/8"	2.36"	0.63"	0.75"	6-32X1/4
C4506-0187	CT45	3/16"	2.50"	0.87"	0.75"	8-32X1/4
C4506-0250	CT45	1/4"	2.50"	1.10"	0.78"	1/4-28X1/4
C4506-0312	CT45	5/16"	2.50"	1.26"	0.87"	5/16-24X1/4
C4506-0375	CT45	3/8"	2.50"	1.26"	1.00"	3/8-24X5/16
C4506-0500	CT45	1/2"	2.50"	1.50"	1.38"	7/16-20X3/8
C4506-0625	CT45	5/8"	3.00"	1.61"	1.65"	9/16-18X1/2
C4506-0750	CT45	3/4"	3.00"	1.77"	1.89"	5/8-18X1/2
C4506-0875	CT45	7/8"	3.50"	2.08"	2.00"	5/8-18X1/2(2)
C4506-1000	CT45	1"	4.00"	2.36"	2.36"	3/4-16X11/16 (2)
C4506-1250	CT45	1-1/4"	4.00"	2.55"	2.48"	3/4-16X11/16 (2)
C4506-1500	CT45	1-1/2"	4.50"	2.83"	2.99"	3/4-16X11/16 (2)
C4506-2000	CT45	2"	5.50"	3.34"	3.74"	1"-14X7/8 (2)

Note: End Mill Holders come equipped with set screws.



END MILL HOLDERS

CT50 END MILL HOLDERS

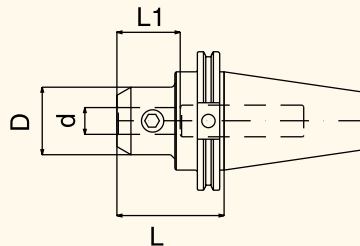

Part Number	Taper	d	L	L1	D	Set Screw
C50S6-0250	CT50	1/4"	1.38"	1.10"	0.79"	1/4-28X1/4
C5006-0250	CT50	1/4"	2.50"	1.10"	0.79"	1/4-28X1/4
C5016-0250	CT50	1/4"	4.00"	1.10"	0.79"	1/4-28X1/4
C5026-0250	CT50	1/4"	6.00"	1.10"	0.79"	1/4-28X1/4
C5036-0250	CT50	1/4"	8.00"	1.10"	0.79"	1/4-28X1/4
C5006-0312	CT50	5/16"	2.50"	1.26"	0.87"	5/16-24X1/4
C5016-0312	CT50	5/16"	4.00"	1.26"	0.87"	5/16-24X1/4
C5026-0312	CT50	5/16"	6.00"	1.26"	0.87"	5/16-24X1/4
C50S6-0375	CT50	3/8"	1.38"	1.26"	1.00"	3/8-24X5/16
C5006-0375	CT50	3/8"	2.50"	1.26"	1.00"	3/8-24X5/16
C5016-0375	CT50	3/8"	4.00"	1.26"	1.00"	3/8-24X5/16
C5026-0375	CT50	3/8"	6.00"	1.26"	1.00"	3/8-24X5/16
C5036-0375	CT50	3/8"	8.00"	1.26"	1.00"	3/8-24X5/16
C5006-0437	CT50	7/16"	2.50"	1.50"	1.38"	7/16-20X3/8
C5016-0437	CT50	7/16"	4.00"	1.50"	1.38"	7/16-20X3/8
C5026-0437	CT50	7/16"	6.00"	1.53"	1.38"	7/16-20X3/8
C5036-0437	CT50	7/16"	8.00"	1.48"	1.38"	7/16-20X3/8
C50S6-0500	CT50	1/2"	1.75"	1.50"	1.38"	7/16-20X3/8
C5006-0500	CT50	1/2"	2.63"	1.50"	1.38"	7/16-20X3/8
C5016-0500	CT50	1/2"	4.00"	1.50"	1.38"	7/16-20X3/8
C5026-0500	CT50	1/2"	6.00"	1.50"	1.38"	7/16-20X3/8
C5036-0500	CT50	1/2"	8.00"	1.48"	1.38"	7/16-20X3/8
C50S6-0625	CT50	5/8"	1.75"	1.61"	1.65"	9/16-18X1/2
C5006-0625	CT50	5/8"	3.00"	1.61"	1.65"	9/16-18X1/2
C5016-0625	CT50	5/8"	4.00"	1.61"	1.65"	9/16-18X1/2
C5026-0625	CT50	5/8"	6.00"	1.61"	1.65"	9/16-18X1/2
C5036-0625	CT50	5/8"	8.00"	1.57"	1.65"	9/16-18X1/2
C50S6-0750	CT50	3/4"	1.75"	1.77"	1.89"	5/8-18X1/2
C5006-0750	CT50	3/4"	3.00"	1.77"	1.89"	5/8-18X1/2
C5016-0750	CT50	3/4"	4.00"	1.77"	1.89"	5/8-18X1/2
C5026-0750	CT50	3/4"	6.00"	1.77"	1.89"	5/8-18X1/2
C5036-0750	CT50	3/4"	8.00"	1.76"	1.89"	5/8-18X1/2
C50S6-0875	CT50	7/8"	1.75"	2.08"	2.00"	5/8-18X1/2
C5006-0875	CT50	7/8"	3.75"	2.08"	2.00"	5/8-18X1/2 (2)
C5016-0875	CT50	7/8"	6.00"	2.08"	2.00"	5/8-18X1/2 (2)

HSBALANCE™ End Mill Holders

For high speed applications, refer to the HSBALANCE™ section starting on page 221 for complete details.



END MILL HOLDERS

CT50 END MILL HOLDERS (cont.)

Part Number	Taper	d	L	L1	D	Set Screw
C50S6-1000	CT50	1"	2.00"	2.36"	2.36"	3/4-16X11/16
C5006-1000	CT50	1"	4.00"	2.36"	2.36"	3/4-16X11/16 (2)
C5016-1000	CT50	1"	6.00"	2.36"	2.36"	3/4-16X11/16 (2)
C5026-1000	CT50	1"	8.00"	2.36"	2.36"	3/4-16X11/16 (2)
C50S6-1250	CT50	1-1/4"	2.00"	2.55"	2.75"	3/4-16X11/16
C5006-1250	CT50	1-1/4"	4.00"	2.55"	2.48"	3/4-16X11/16 (2)
C5016-1250	CT50	1-1/4"	6.00"	2.55"	2.48"	3/4-16X11/16 (2)
C5026-1250	CT50	1-1/4"	8.00"	2.55"	2.48"	3/4-16X11/16 (2)
C50S6-1500	CT50	1-1/2"	2.25"	2.83"	2.75"	3/4-16X11/16
C5006-1500	CT50	1-1/2"	4.50"	2.83"	2.99"	3/4-16X11/16 (2)
C5016-1500	CT50	1-1/2"	7.00"	2.83"	2.99"	3/4-16X11/16 (2)
C5026-1500	CT50	1-1/2"	9.00"	2.83"	2.99"	3/4-16X11/16 (2)
C50S6-2000	CT50	2"	3.63"	3.34"	3.74"	1"-14X7/8 (2)
C5006-2000	CT50	2"	5.37"	3.34"	3.74"	1"-14X7/8 (2)
C5016-2000	CT50	2"	8.00"	3.34"	3.74"	1"-14X7/8 (2)
C5026-2000	CT50	2"	10.00"	3.34"	3.74"	1"-14X7/8 (2)
C5006-2500	CT50	2-1/2"	6.00"	3.66"	4.25"	1"-14X7/8 (2)

CT50 END MILL HOLDERS (METRIC)

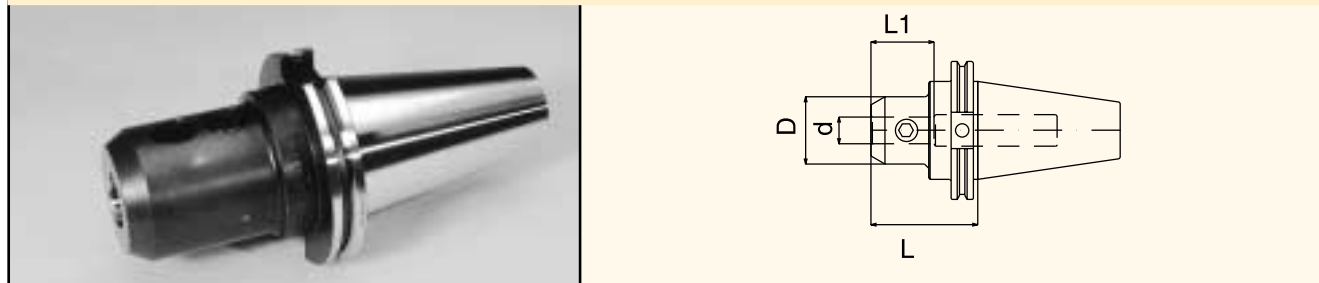

Part Number	Taper	d	L	L1	D	Set Screw
C5006-6	CT50	6mm	2.50"	1.10"	0.79"	1/4-28X1/4
C5006-8	CT50	8mm	2.50"	1.10"	0.87"	5/16-24X1/4
C5006-10	CT50	10mm	2.50"	1.26"	1.00"	3/8-24X5/16
C5006-12	CT50	12mm	2.63"	1.50"	1.38"	7/16-20X3/8
C5006-14	CT50	14mm	3.00"	1.61"	1.65"	9/16-18X1/2
C5006-16	CT50	16mm	3.00"	1.61"	1.65"	9/16-18X1/2
C5006-18	CT50	18mm	3.00"	1.77"	1.89"	5/8-18X1/2
C5006-20	CT50	20mm	3.00"	1.77"	1.89"	5/8-18X1/2
C5006-25	CT50	25mm	4.00"	2.36"	2.36"	3/4-16X11/16 (2)
C5006-32	CT50	32mm	4.00"	2.55"	2.48"	3/4-16X11/16 (2)
C5006-40	CT50	40mm	4.50"	2.95"	3.07"	3/4-16X11/16 (2)
C5006-42	CT50	42mm	4.50"	2.83"	3.07"	3/4-16X11/16 (2)
C5006-50	CT50	50mm	5.37"	3.35"	3.74"	1"-14X7/8 (2)

Note: End Mill Holders come equipped with set screws.



END MILL HOLDERS

CT50 END MILL HOLDERS - DIN

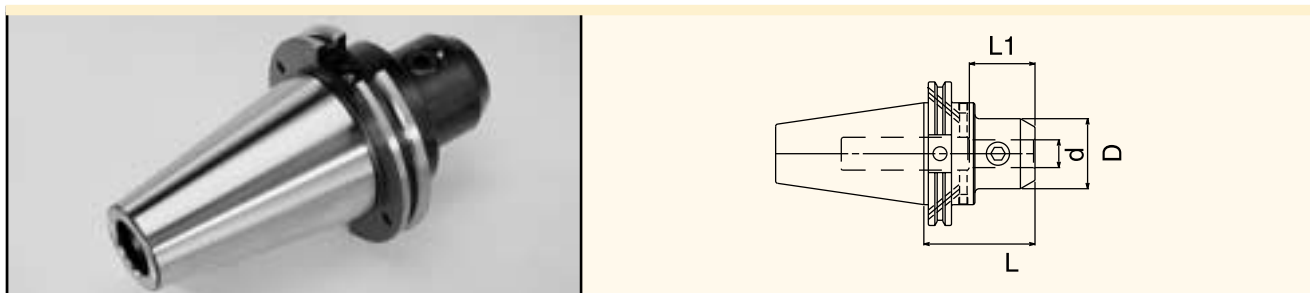

Part Number	Taper	d	L	L1	D	Set Screw
C5006-0250DIN	CT50	1/4"	2.50"	1.10"	0.79"	1/4-28X1/4
C5016-0250DIN	CT50	1/4"	4.00"	1.10"	0.79"	1/4-28X1/4
C5026-0250DIN	CT50	1/4"	6.00"	1.10"	0.79"	1/4-28X1/4
C5006-0312DIN	CT50	5/16"	2.50"	1.26"	0.87"	5/16-24X1/4
C5016-0312DIN	CT50	5/16"	4.00"	1.30"	0.87"	5/16-24X1/4
C5026-0312DIN	CT50	5/16"	6.00"	1.30"	0.87"	5/16-24X1/4
C5006-0375DIN	CT50	3/8"	2.50"	1.26"	1.00"	3/8-24X5/16
C5016-0375DIN	CT50	3/8"	4.00"	1.26"	1.00"	3/8-24X5/16
C5026-0375DIN	CT50	3/8"	6.00"	1.26"	1.00"	3/8-24X5/16
C5006-0437DIN	CT50	7/16"	2.50"	1.50"	1.38"	7/16-20X3/8
C5016-0437DIN	CT50	7/16"	4.00"	1.50"	1.38"	7/16-20X3/8
C5026-0437DIN	CT50	7/16"	6.00"	1.53"	1.38"	7/16-20X3/8
C5006-0500DIN	CT50	1/2"	2.63"	1.50"	1.38"	7/16-20X3/8
C5016-0500DIN	CT50	1/2"	4.00"	1.50"	1.38"	7/16-20X3/8
C5026-0500DIN	CT50	1/2"	6.00"	1.50"	1.38"	7/16-20X3/8
C5006-0625DIN	CT50	5/8"	3.00"	1.61"	1.65"	9/16-18X1/2
C5016-0625DIN	CT50	5/8"	4.00"	1.61"	1.65"	9/16-18X1/2
C5026-0625DIN	CT50	5/8"	6.00"	1.61"	1.65"	9/16-18X1/2
C5006-0750DIN	CT50	3/4"	3.00"	1.77"	1.89"	5/8-18X1/2
C5016-0750DIN	CT50	3/4"	4.00"	1.77"	1.89"	5/8-18X1/2
C5026-0750DIN	CT50	3/4"	6.00"	1.77"	1.89"	5/8-18X1/2
C5006-0875DIN	CT50	7/8"	3.75"	2.08"	2.00"	5/8-18X1/2 (2)
C5016-0875DIN	CT50	7/8"	6.00"	2.08"	2.00"	5/8-18X1/2 (2)
C5026-0875DIN	CT50	7/8"	8.00"	2.08"	2.00"	5/8-18X1/2 (2)
C5006-1000DIN	CT50	1"	4.00"	2.36"	2.36"	3/4-16X11/16 (2)
C5016-1000DIN	CT50	1"	6.00"	2.36"	2.36"	3/4-16X11/16 (2)
C5026-1000DIN	CT50	1"	8.00"	2.36"	2.36"	3/4-16X11/16 (2)
C5006-1250DIN	CT50	1-1/4"	4.00"	2.55"	2.48"	3/4-16X11/16 (2)
C5016-1250DIN	CT50	1-1/4"	6.00"	2.55"	2.48"	3/4-16X11/16 (2)
C5026-1250DIN	CT50	1-1/4"	8.00"	2.55"	2.48"	3/4-16X11/16 (2)
C5006-1500DIN	CT50	1-1/2"	4.50"	2.75"	2.99"	3/4-16X11/16 (2)
C5016-1500DIN	CT50	1-1/2"	7.00"	2.75"	2.99"	3/4-16X11/16 (2)
C5026-1500DIN	CT50	1-1/2"	9.00"	2.75"	2.99"	3/4-16X11/16 (2)
C5006-2000DIN	CT50	2"	5.37"	3.34"	3.74"	1"-14X7/8 (2)
C5006-2500DIN	CT50	2-1/2"	6.00"	3.66"	4.25"	1"-14X7/8 (2)

HSBALANCE™ End Mill Holders

For high speed applications, refer to the HSBALANCE™ section starting on page 221 for complete details.



END MILL HOLDERS

CT50 END MILL HOLDERS (METRIC) - DIN

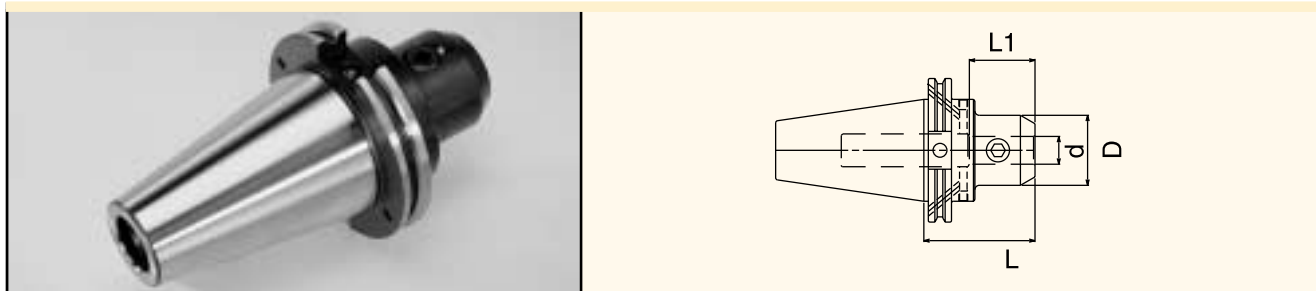

Part Number	Taper	d	L	L1	D	Set Screw
C5006-6DIN	CT50	6mm	2.50"	1.10"	0.79"	1/4-28X1/4
C5006-8DIN	CT50	8mm	2.50"	1.10"	0.87"	5/16-24X1/4
C5006-10DIN	CT50	10mm	2.50"	1.26"	1.00"	3/8-24X5/16
C5006-12DIN	CT50	12mm	2.63"	1.50"	1.38"	7/16-20X3/8
C5006-14DIN	CT50	14mm	3.00"	1.61"	1.65"	9/16-18X1/2
C5006-16DIN	CT50	16mm	3.00"	1.61"	1.65"	9/16-18X1/2
C5006-18DIN	CT50	18mm	3.00"	1.77"	1.89"	5/8-18X1/2
C5006-20DIN	CT50	20mm	3.00"	1.77"	1.89"	5/8-18X1/2
C5006-25DIN	CT50	25mm	4.00"	2.36"	2.36"	3/4-16X11/16 (2)
C5006-32DIN	CT50	32mm	4.00"	2.55"	2.48"	3/4-16X11/16 (2)
C5006-40DIN	CT50	40mm	4.50"	2.76"	3.07"	3/4-16X11/16 (2)
C5006-42DIN	CT50	42mm	4.50"	2.76"	3.07"	3/4-16X11/16 (2)
C5006-50DIN	CT50	50mm	5.37"	3.35"	3.74"	1-14X7/8 (2)

Note: "DIN" designates suitability for coolant through the flange per DIN 69871 Form B specs.
End Mill Holders come equipped with set screws.

HSBALANCE™ End Mill Holders

For high speed applications, refer to the HSBALANCE™ section starting on page 221 for complete details.



END MILL HOLDERS

CT50 AEROSPACE END MILL HOLDERS

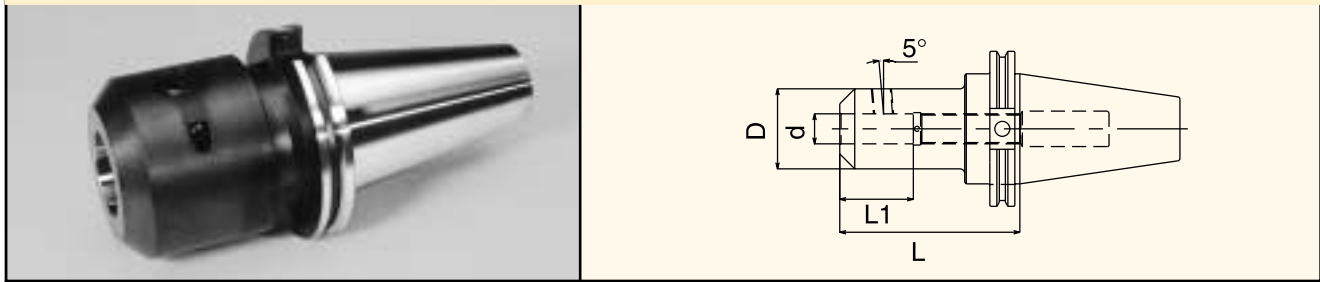

Part Number	Taper	d	L	L1	D	Set Screw
C5006-0375A	CT50	3/8"	2.82"	1.52"	1.37"	3/8-24UNF
C5016-0375A	CT50	3/8"	4.69"	1.52"	1.37"	3/8-24UNF
C5026-0375A	CT50	3/8"	6.69"	1.52"	1.37"	3/8-24UNF
C5006-0500A	CT50	1/2"	2.73"	1.68"	1.63"	3/8-24UNF
C5016-0500A	CT50	1/2"	4.60"	1.68"	1.63"	3/8-24UNF
C5026-0500A	CT50	1/2"	6.60"	1.68"	1.63"	3/8-24UNF
C5006-0625A	CT50	5/8"	2.66"	1.74"	1.81"	1/2-20UNF
C5016-0625A	CT50	5/8"	4.53"	1.74"	1.81"	1/2-20UNF
C5026-0625A	CT50	5/8"	6.53"	1.74"	1.81"	1/2-20UNF
C5006-0750A	CT50	3/4"	2.63"	2.01"	2.00"	1/2-20UNF
C5016-0750A	CT50	3/4"	4.50"	2.01"	2.00"	1/2-20UNF
C5026-0750A	CT50	3/4"	6.50"	2.01"	2.00"	1/2-20UNF
C5006-0875A	CT50	7/8"	2.63"	2.01"	2.25"	1/2-20UNF
C5016-0875A	CT50	7/8"	4.50"	2.01"	2.25"	1/2-20UNF
C5026-0875A	CT50	7/8"	6.50"	2.01"	2.25"	1/2-20UNF
C5006-1000A	CT50	1"	3.00"	2.27"	2.63"	3/4-16UNF
C5016-1000A	CT50	1"	4.50"	2.27"	2.63"	3/4-16UNF
C5026-1000A	CT50	1"	6.50"	2.27"	2.63"	3/4-16UNF
C5006-1250A	CT50	1-1/4"	3.00"	2.27"	2.87"	3/4-16UNF
C5016-1250A	CT50	1-1/4"	4.50"	2.27"	2.87"	3/4-16UNF
C5026-1250A	CT50	1-1/4"	6.50"	2.27"	2.87"	3/4-16UNF
C5006-1500A	CT50	1-1/2"	4.00"	2.27"	3.25"	3/4-16UNF
C5006-2000A	CT50	2"	5.35"	3.38"	4.00"	3/4-16UNF(2)
C5016-2000A	CT50	2"	7.35"	3.38"	4.00"	3/4-16UNF(2)
C5006-2500A	CT50	2-1/2"	5.35"	3.38"	5.00"	3/4-16UNF(2)
C5016-2500A	CT50	2-1/2"	7.35"	3.38"	5.00"	3/4-16UNF(2)

Note: Lyndex Aerospace End Mill Holders accept end mills with a 5° angled flat shank (per NAS 987).
End Mill Holders come equipped with set screws.

HSBALANCE™ End Mill Holders

For high speed applications, refer to the HSBALANCE™ section starting on page 221 for complete details.



END MILL HOLDERS

BT30 END MILL HOLDERS

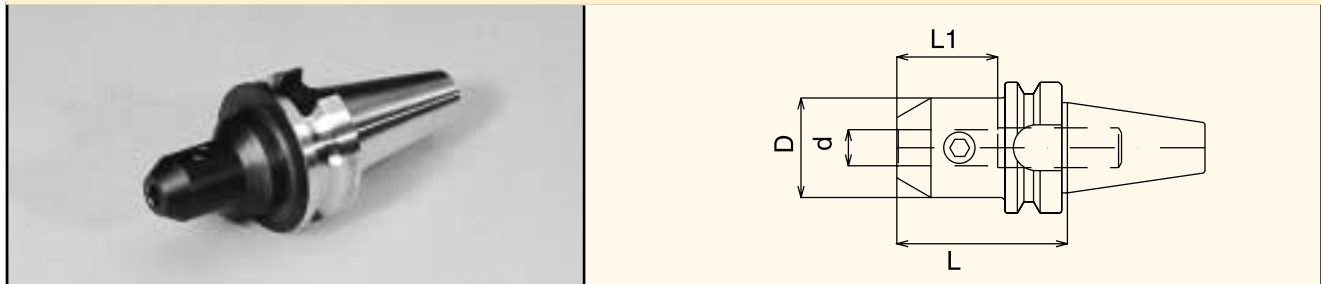

Part Number	Taper	d	L	L1	D	Set Screw
B3006-0125	BT30	1/8"	2.36"	0.63"	0.75"	6-32X1/4
B3006-0187	BT30	3/16"	2.36"	0.87"	0.75"	8-32X1/4
B3006-0250	BT30	1/4"	2.36"	1.10"	0.79"	1/4-28X1/4
B3006-0312	BT30	5/16"	2.36"	1.26"	0.87"	5/16-24X1/4
B3006-0375	BT30	3/8"	2.36"	1.26"	1.00"	3/8-24X5/16
B3006-0437	BT30	7/16"	2.36"	1.50"	1.38"	7/16-20X3/8
B3006-0500	BT30	1/2"	2.36"	1.50"	1.38"	7/16-20X3/8
B3006-0625	BT30	5/8"	2.50"	1.61"	1.65"	9/16-18X1/2
B3006-0750	BT30	3/4"	3.00"	1.77"	1.88"	5/8-18X1/2
B3006-0875	BT30	7/8"	3.54"	2.09"	2.00"	5/8-18X1/2 (2)
B3006-1000	BT30	1"	3.54"	2.36"	2.36"	3/4-16X11/16 (2)

BT30 END MILL HOLDERS (METRIC)

Part Number	Taper	d	L	L1	D	Set Screw
B3006-6	BT30	6mm	2.50"	1.10"	0.79"	1/4-28X1/4
B3006-8	BT30	8mm	2.50"	1.26"	0.87"	5/16-24X1/4
B3006-10	BT30	10mm	2.50"	1.26"	1.00"	3/8-24X5/16
B3006-12	BT30	12mm	2.50"	1.50"	1.38"	7/16-20X3/8
B3006-14	BT30	14mm	2.50"	1.61"	1.65"	9/16-18X1/2
B3006-16	BT30	16mm	2.50"	1.61"	1.65"	9/16-18X1/2
B3006-18	BT30	18mm	3.50"	1.65"	1.89"	5/8-18X1/2
B3006-20	BT30	20mm	3.50"	1.65"	1.89"	5/8-18X1/2
B3006-25	BT30	25mm	3.50"	2.36"	2.36"	3/4-16X11/16(2)

Note: End Mill Holders come equipped with set screws.



END MILL HOLDERS

BT35 END MILL HOLDERS

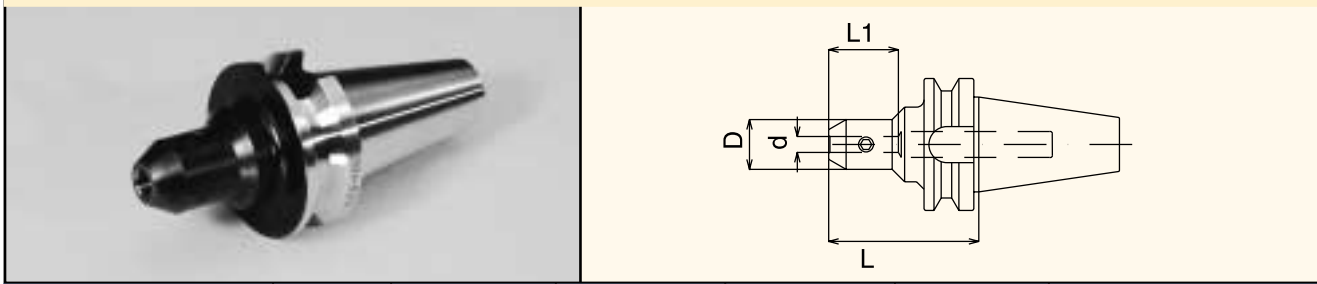

Part Number	Taper	d	L	L1	D	Set Screw
B3506-0125	BT35	1/8"	2.36"	0.63"	0.75"	6-32X1/4
B3506-0187	BT35	3/16"	2.38"	0.87"	0.75"	8-32X1/4
B3506-0250	BT35	1/4"	2.38"	1.10"	0.79"	1/4-28X1/4
B3506-0312	BT35	5/16"	2.38"	1.26"	0.87"	5/16-24X1/4
B3506-0375	BT35	3/8"	2.38"	1.26"	1.00"	3/8-24X5/16
B3506-0437	BT35	7/16"	2.38"	1.50"	1.38"	7/16-20X3/8
B3506-0500	BT35	1/2"	2.38"	1.50"	1.38"	7/16-20X3/8
B3506-0625	BT35	5/8"	2.50"	1.61"	1.65"	9/16-18X1/2
B3506-0750	BT35	3/4"	2.50"	1.77"	1.89"	5/8-18X1/2
B3506-0875	BT35	7/8"	3.50"	2.09"	2.00"	5/8-18X1/2 (2)
B3506-1000	BT35	1"	3.50"	2.36"	2.36"	3/4-16X11/16 (2)
B3506-1250	BT35	1-1/4"	3.50"	2.24"	2.48"	3/4-16X11/16 (2)

Note: End Mill Holders come equipped with set screws.

hsBALANCE™ End Mill Holders

For high speed applications, refer to the hsBALANCE™ section starting on page 221 for complete details.

END MILL HOLDERS

BT40 END MILL HOLDERS

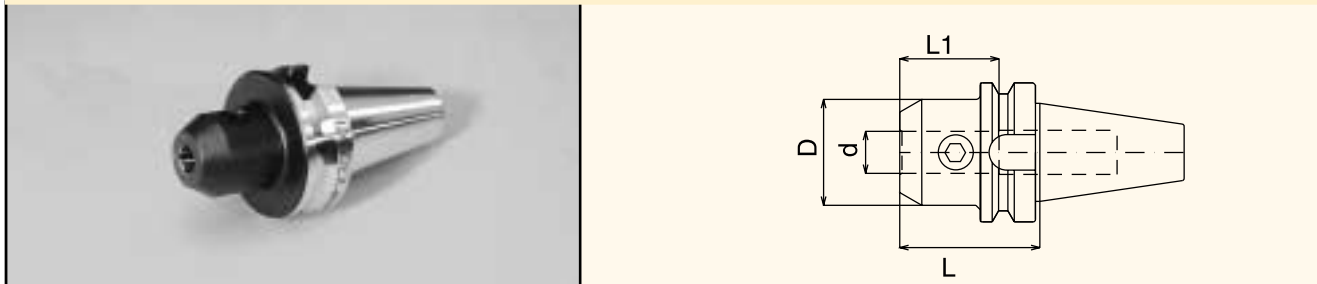

Part Number	Taper	d	L	L1	D	Set Screw
B40S6-0125	BT40	1/8"	1.38"	0.78"	0.75"	6-32X1/4
B4006-0125	BT40	1/8"	2.36"	0.63"	0.75"	6-32X1/4
B4016-0125	BT40	1/8"	4.00"	0.63"	0.75"	6-32X1/4
B40S6-0187	BT40	3/16"	1.38"	0.98"	0.75"	8-32X1/4
B4006-0187	BT40	3/16"	2.50"	0.86"	0.75"	8-32X1/4
B4016-0187	BT40	3/16"	4.00"	0.86"	0.75"	8-32X1/4
B40S6-0250	BT40	1/4"	1.38"	1.18"	0.79"	1/4-28X1/4
B4006-0250	BT40	1/4"	2.50"	1.10"	0.79"	1/4-28X1/4
B4016-0250	BT40	1/4"	4.00"	1.10"	0.79"	1/4-28X1/4
B40S6-0312	BT40	5/16"	1.38"	1.38"	0.87"	5/16-24X1/4
B4006-0312	BT40	5/16"	2.50"	1.26"	0.87"	5/16-24X1/4
B4016-0312	BT40	5/16"	4.00"	1.26"	0.87"	5/16-24X1/4
B40S6-0375	BT40	3/8"	1.38"	1.38"	1.00"	3/8-24x5/16
B4006-0375	BT40	3/8"	2.50"	1.26"	1.00"	3/8-24x5/16
B4016-0375	BT40	3/8"	4.00"	1.26"	1.00"	3/8-24x5/16
B4006-0437	BT40	7/16"	2.50"	1.53"	1.38"	7/16-20X3/8
B40S6-0500	BT40	1/2"	1.75"	1.57"	1.38"	7/16-20X3/8
B4006-0500	BT40	1/2"	2.50"	1.50"	1.38"	7/16-20X3/8
B4016-0500	BT40	1/2"	4.00"	1.57"	1.38"	7/16-20X3/8
B40S6-0625	BT40	5/8"	1.75"	1.61"	1.65"	9/16-18X1/2
B4006-0625	BT40	5/8"	2.50"	1.61"	1.65"	9/16-20X1/2
B4016-0625	BT40	5/8"	4.00"	1.61"	1.65"	9/16-18X1/2
B40S6-0750	BT40	3/4"	1.75"	1.77"	1.89"	5/8-18X1/2
B4006-0750	BT40	3/4"	2.50"	1.77"	1.89"	5/8-18X1/2
B4016-0750	BT40	3/4"	4.00"	1.77"	1.89"	5/8-18X1/2
B4006-0875	BT40	7/8"	3.38"	2.08"	2.00"	5/8-18X1/2(2)
B4016-0875	BT40	7/8"	6.00"	2.08"	2.00"	5/8-18X1/2(2)
B40S6-1000	BT40	1"	2.00"	2.28"	2.25"	3/4-16X11/16
B4006-1000	BT40	1"	3.56"	2.36"	2.36"	3/4-16X11/16(2)
B4016-1000	BT40	1"	6.00"	2.36"	2.36"	3/4-16X11/16(2)
B40S6-1250	BT40	1-1/4"	2.00"	2.16"	2.25"	3/4-16X11/16
B4006-1250	BT40	1-1/4"	3.56"	2.56"	2.48"	3/4-16X11/16(2)
B4016-1250	BT40	1-1/4"	6.00"	2.56"	2.48"	3/4-16X11/16(2)
B4006-1500	BT40	1-1/2"	4.50"	2.83"	2.99"	3/4-16X11/16(2)
B4016-1500	BT40	1-1/2"	6.00"	2.83"	2.99"	3/4-16X11/16(2)



END MILL HOLDERS

CUSTOM TOOLS

PRESETTERS

END MILL HOLDERS

SHELL MILL HOLDERS

MILLING CHUCKS

COLLET CHUCKS

HYDRAULIC CHUCKS

DRILL CHUCKS

TAP HOLDERS

BT40 END MILL HOLDERS (METRIC)

Part Number	Taper	d	L	L1	D	Set Screw
B4006-6	BT40	6mm	2.50"	1.10"	0.79"	1/4-28X1/4
B4016-6	BT40	6mm	4.00"	1.10"	0.79"	1/4-28X1/4
B4006-8	BT40	8mm	2.50"	1.26"	0.87"	5/16-24X1/4
B4016-8	BT40	8mm	4.00"	1.26"	0.87"	5/16-24X1/4
B4006-10	BT40	10mm	2.50"	1.26"	1.00"	3/8-24X5/16
B4016-10	BT40	10mm	4.00"	1.26"	1.00"	3/8-24X5/16
B4006-12	BT40	12mm	2.50"	1.50"	1.38"	7/16-20X3/8
B4016-12	BT40	12mm	4.00"	1.50"	1.38"	7/16-20X3/8
B4006-14	BT40	14mm	2.50"	1.61"	1.65"	9/16-18X1/2
B4016-14	BT40	14mm	4.00"	1.61"	1.65"	9/16-18X1/2
B4006-16	BT40	16mm	2.50"	1.61"	1.65"	9/16-18X1/2
B4016-16	BT40	16mm	4.00"	1.61"	1.65"	9/16-18X1/2
B4006-18	BT40	18mm	2.50"	1.77"	1.89"	5/8-18X1/2
B4016-18	BT40	18mm	4.00"	1.77"	1.89"	5/8-18X1/2
B4006-20	BT40	20mm	2.50"	1.77"	1.89"	5/8-18X1/2
B4016-20	BT40	20mm	4.00"	1.77"	1.89"	5/8-18X1/2
B4006-25	BT40	25mm	3.56"	2.36"	2.36"	3/4-16X11/16(2)
B4016-25	BT40	25mm	6.00"	2.36"	2.36"	3/4-16X11/16(2)
B4006-32	BT40	32mm	3.56"	2.56"	2.48"	3/4-16X11/16(2)
B4016-32	BT40	32mm	6.00"	2.56"	2.48"	3/4-16X11/16(2)

BT45 END MILL HOLDERS

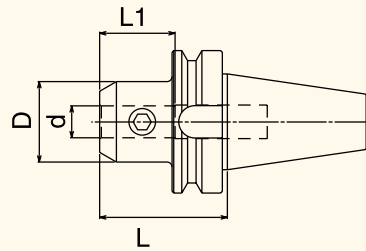

Part Number	Taper	d	L	L1	D	Set Screw
B4506-0125	BT45	1/8"	3.00"	0.63"	0.75"	6-32X1/4
B4506-0187	BT45	3/16"	3.00"	0.87"	0.75"	8-32X1/4
B4506-0250	BT45	1/4"	3.00"	1.10"	0.79"	1/4-28X1/4
B4506-0312	BT45	5/16"	3.00"	1.26"	0.87"	5/16-24X1/4
B4506-0375	BT45	3/8"	3.00"	1.26"	1.00"	3/8-24X5/16
B4506-0500	BT45	1/2"	3.00"	1.53"	1.38"	7/16-20X3/8
B4506-0625	BT45	5/8"	3.00"	1.61"	1.65"	9/16-18X1/2
B4506-0750	BT45	3/4"	3.00"	1.77"	1.89"	5/8-18X1/2
B4506-0875	BT45	7/8"	4.00"	2.08"	2.00"	5/8-18X1/2(2)
B4506-1000	BT45	1"	4.00"	2.36"	2.36"	3/4-16X11/16(2)
B4506-1250	BT45	1-1/4"	4.00"	2.55"	2.48"	3/4-16X11/16(2)
B4506-1500	BT45	1-1/2"	4.50"	2.83"	3.00"	3/4-16X11/16(2)
B4506-2000	BT45	2"	5.00"	3.34"	3.75"	1-14X7/8(2)

Note: End Mill Holders come equipped with set screws.

HSBALANCE™ End Mill Holders

For high speed applications, refer to the HSBALANCE™ section starting on page 221 for complete details.



END MILL HOLDERS

BT50 END MILL HOLDERS

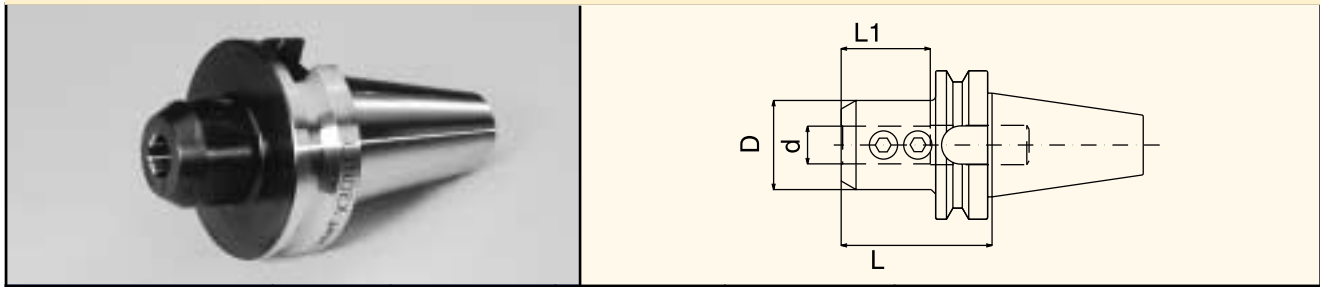

Part Number	Taper	d	L	L1	D	Set Screw
B5006-0250	BT50	1/4"	3.00"	1.10"	0.78"	1/4-28X1/4
B5016-0250	BT50	1/4"	6.00"	1.10"	0.78"	1/4-28X1/4
B5006-0375	BT50	3/8"	2.75"	1.26"	1.00"	3/8-24X5/16
B5016-0375	BT50	3/8"	6.00"	1.26"	1.00"	3/8-24X5/16
B5006-0500	BT50	1/2"	3.00"	1.50"	1.38"	7/16-20X3/8
B5016-0500	BT50	1/2"	6.00"	1.50"	1.38"	7/16-20X3/8
B5006-0625	BT50	5/8"	3.00"	1.61"	1.65"	9/16-18X1/2
B5016-0625	BT50	5/8"	6.00"	1.61"	1.65"	9/16-18X1/2
B5006-0750	BT50	3/4"	3.00"	1.77"	1.89"	5/8-18X1/2
B5016-0750	BT50	3/4"	6.00"	1.77"	1.89"	5/8-18X1/2
B5006-0875	BT50	7/8"	4.00"	2.08"	2.00"	5/8-18X1/2 (2)
B5016-0875	BT50	7/8"	6.00"	2.08"	2.00"	5/8-18X1/2 (2)
B5006-1000	BT50	1"	4.00"	2.36"	2.36"	3/4-16X11/16 (2)
B5016-1000	BT50	1"	6.00"	2.36"	2.36"	3/4-16X11/16 (2)
B5006-1250	BT50	1-1/4"	4.00"	2.56"	2.48"	3/4-16X11/16 (2)
B5016-1250	BT50	1-1/4"	6.00"	2.56"	2.48"	3/4-16X11/16 (2)
B5006-1500	BT50	1-1/2"	4.50"	2.83"	2.99"	3/4-16X11/16 (2)
B5016-1500	BT50	1-1/2"	7.00"	2.83"	2.99"	3/4-16X11/16 (2)
B5006-2000	BT50	2"	5.00"	3.34"	3.74"	1-14X7/8 (2)
B5016-2000	BT50	2"	8.00"	3.34"	3.74"	1-14X7/8 (2)
B5006-2500	BT50	2-1/2"	6.00"	3.66"	4.25"	1-14X7/8 (2)

BT50 END MILL HOLDERS (METRIC)

Part Number	Taper	d	L	L1	D	Set Screw
B5006-6	BT50	6mm	2.50"	1.10"	0.79"	1/4-28X1/4
B5006-8	BT50	8mm	2.50"	1.25"	0.87"	5/16-24X1/4
B5006-10	BT50	10mm	2.75"	1.25"	1.00"	3/8-24X5/16
B5006-12	BT50	12mm	3.00"	1.50"	1.38"	7/16-20X3/8
B5006-14	BT50	14mm	3.00"	1.61"	1.65"	9/16-18X1/2
B5006-16	BT50	16mm	3.00"	1.61"	1.65"	9/16-18X1/2
B5006-18	BT50	18mm	3.00"	1.77"	1.89"	5/8-18X1/2
B5006-20	BT50	20mm	3.00"	1.77"	1.89"	5/8-18X1/2
B5006-25	BT50	25mm	4.00"	2.36"	2.36"	3/4-16X11/16 (2)
B5006-32	BT50	32mm	4.00"	2.55"	2.48"	3/4-16X11/16 (2)
B5006-40	BT50	40mm	4.49"	2.83"	3.07"	3/4-16X11/16 (2)
B5006-42	BT50	42mm	4.49"	2.83"	3.07"	3/4-16X11/16 (2)
B5006-50	BT50	50mm	5.00"	3.34"	3.74"	1-14X7/8 (2)

Note: End Mill Holders come equipped with set screws.



END MILL HOLDERS

NMTB30 END MILL HOLDERS

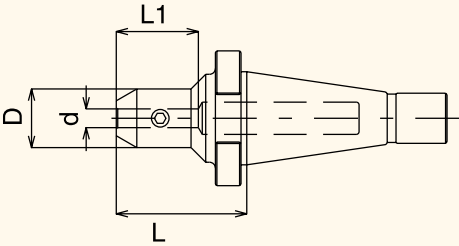
						
Part Number	Taper	d	L	L1	D	Set Screw
N3006-0125	NMTB30	1/8"	1.75"	0.63"	0.75"	6-32X1/4
N3006-0187	NMTB30	3/16"	1.75"	0.87"	0.75"	8-32X1/4
N3006-0250	NMTB30	1/4"	1.75"	1.10"	0.79"	1/4-28X1/4
N3006-0312	NMTB30	5/16"	1.75"	1.26"	0.87"	5/16-24X1/4
N3006-0375	NMTB30	3/8"	1.75"	1.26"	1.00"	3/8-24X5/16
N3006-0500	NMTB30	1/2"	1.75"	1.57"	1.38"	7/16-20X3/8
N3006-0625	NMTB30	5/8"	1.75"	1.69"	1.43"	9/16-18X1/2
N3006-0750	NMTB30	3/4"	2.25"	1.85"	1.89"	5/8-18X1/2
N3006-0875	NMTB30	7/8"	2.50"	1.96"	2.01"	5/8-18X1/2
N3006-1000	NMTB30	1"	2.69"	2.24"	2.36"	3/4-16X11/16
N3006-1250	NMTB30	1-1/4"	3.62"	2.24"	2.48"	3/4-16X11/16 (2)

NMTB40 END MILL HOLDERS

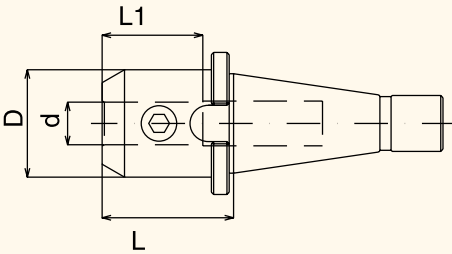
						
Part Number	Taper	d	L	L1	D	Set Screw
N4006-0125	NMTB40	1/8"	2.31"	0.63"	0.75"	6-32X1/4
N4006-0187	NMTB40	3/16"	2.31"	0.87"	0.75"	8-32X1/4
N4006-0250	NMTB40	1/4"	2.31"	1.10"	0.79"	1/4-28X1/4
N4006-0312	NMTB40	5/16"	2.31"	1.26"	0.87"	5/16-24X1/4
N4006-0375	NMTB40	3/8"	2.31"	1.26"	1.00"	3/8-24X5/16
N4006-0437	NMTB40	7/16"	2.31"	1.50"	1.38"	7/16-20X3/8
N4006-0500	NMTB40	1/2"	2.31"	1.50"	1.38"	7/16-20X3/8
N4006-0625	NMTB40	5/8"	2.31"	1.61"	1.65"	9/16-18X1/2
N4006-0750	NMTB40	3/4"	2.31"	1.77"	1.89"	5/8-18X1/2
N4006-0875	NMTB40	7/8"	2.94"	2.09"	2.01"	5/8-18X1/2 (2)
N4006-1000	NMTB40	1"	3.37"	2.36"	2.36"	3/4-16X11/16 (2)
N4006-1250	NMTB40	1-1/4"	3.69"	2.56"	2.48"	3/4-16X11/16 (2)
N4006-1500	NMTB40	1-1/2"	3.95"	2.56"	2.99"	3/4-16X11/16 (2)

Note: All NMTB toolholder flanges are qualified for use with Erickson QC spindles. End Mill Holders come equipped with set screws.

END MILL HOLDERS

NMTB50 END MILL HOLDERS

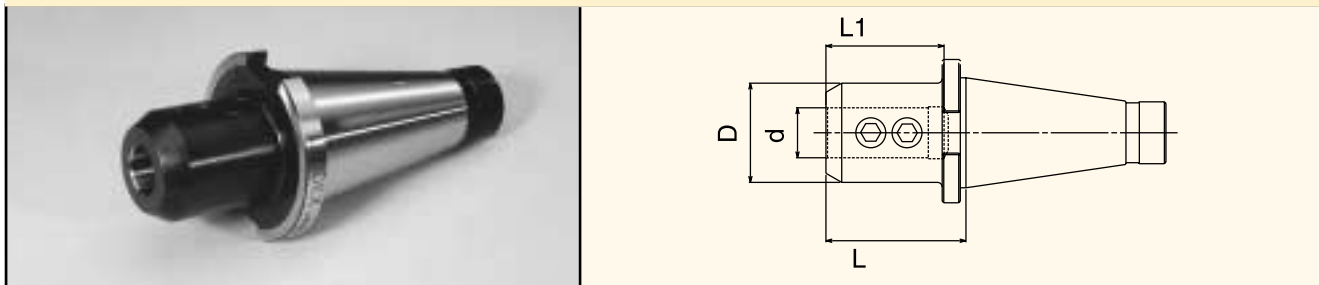

Part Number	Taper	d	L	L1	D	Set Screw
N5006-0250	NMTB50	1/4"	2.75"	1.10"	0.79"	1/4-28X1/4
N5006-0375	NMTB50	3/8"	2.75"	1.26"	1.00"	3/8-24X5/16
N5016-0375	NMTB50	3/8"	4.50"	1.26"	1.00"	3/8-24X5/16
N5006-0500	NMTB50	1/2"	2.75"	1.50"	1.38"	7/16-20X3/8
N5016-0500	NMTB50	1/2"	4.50"	1.50"	1.38"	7/16-20X3/8
N5006-0625	NMTB50	5/8"	2.75"	1.61"	1.65"	9/16-18X1/2
N5016-0625	NMTB50	5/8"	4.50"	1.61"	1.65"	9/16-18X1/2
N5006-0750	NMTB50	3/4"	2.88"	1.77"	1.89"	5/8-18X1/2
N5016-0750	NMTB50	3/4"	4.50"	1.77"	1.89"	5/8-18X1/2
N5006-0875	NMTB50	7/8"	2.88"	2.09"	2.01"	5/8-18X1/2 (2)
N5016-0875	NMTB50	7/8"	4.50"	2.09"	2.01"	5/8-18X1/2 (2)
N5006-1000	NMTB50	1"	3.50"	2.36"	2.36"	3/4-16X11/16 (2)
N5016-1000	NMTB50	1"	5.50"	2.36"	2.36"	3/4-16X11/16 (2)
N5006-1250	NMTB50	1-1/4"	3.50"	2.56"	2.48"	3/4-16X11/16 (2)
N5016-1250	NMTB50	1-1/4"	5.50"	2.56"	2.48"	3/4-16X11/16 (2)
N5006-1500	NMTB50	1-1/2"	4.00"	2.83"	2.99"	3/4-16X11/16 (2)
N5016-1500	NMTB50	1-1/2"	6.00"	2.83"	2.99"	3/4-16X11/16 (2)
N5006-2000	NMTB50	2"	4.69"	3.34"	3.74"	1-14X7/8 (2)

Note: All NMTB toolholder flanges are qualified for use with Erickson QC spindles. End Mill Holders come equipped with set screws.

R8 END MILL HOLDERS

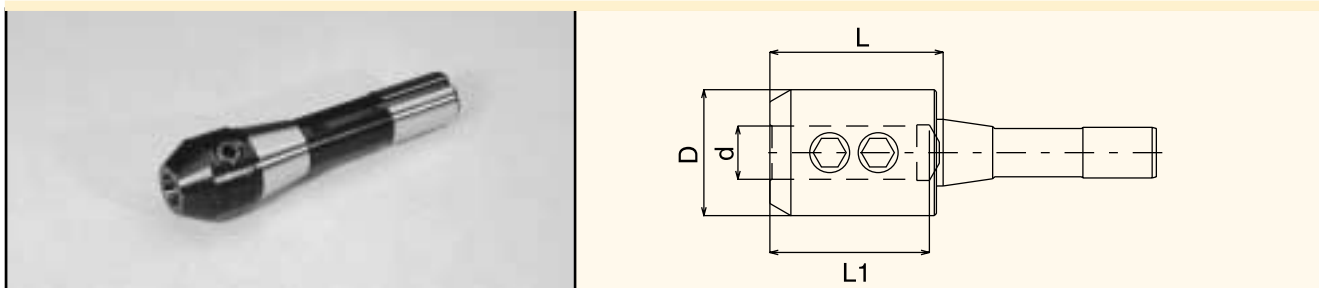

Part Number	Taper	d	L	L1	D	Set Screw
830-008	R8	1/8"	1.33"	0.63"	0.75"	6-32X1/4
830-012	R8	3/16"	1.33"	0.87"	0.75"	8-32X1/4
830-016	R8	1/4"	1.33"	1.10"	0.79"	1/4-28X1/4
830-020	R8	5/16"	1.75"	1.26"	0.87"	5/16-24X1/4
830-024	R8	3/8"	1.33"	1.26"	1.00"	3/8-24X5/16
830-028	R8	7/16"	1.33"	1.50"	1.38"	7/16-20X3/8
830-032	R8	1/2"	1.33"	1.50"	1.38"	7/16-20X3/8
830-040	R8	5/8"	1.50"	1.61"	1.65"	9/16-18X1/2
830-048	R8	3/4"	2.37"	1.77"	1.89"	5/8-18X1/2
830-056	R8	7/8"	2.75"	2.36"	2.01"	5/8-18X1/2 (2)
830-064	R8	1"	3.25"	2.76"	2.36"	3/4-16X11/16 (2)
830-080	R8	1-1/4"	3.25"	2.56"	2.48"	3/4-16X11/16 (2)
830-096	R8	1-1/2"	3.75"	2.83"	2.99"	3/4-16X11/16 (2)



END MILL HOLDERS

STRAIGHT SHANK END MILL HOLDERS

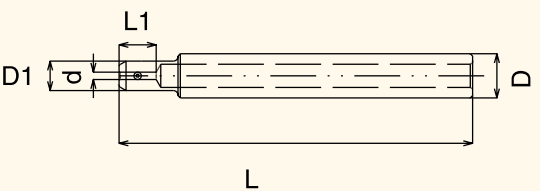
						
Part Number	d	L	L1	D	D1	Set Screw
S7506-0125	1/8"	6.00"	0.63"	.750"	0.50"	6-32X1/4
S7506-0187	3/16"	6.00"	0.86"	.750"	0.56"	8-32X1/4
S7506-0250	1/4"	6.00"	1.10"	.750"	0.75"	1/4-28X1/4
S7506-0312	5/16"	6.00"	1.26"	.750"	0.75"	5/16-24X1/4
S1006-0375	3/8"	6.00"	1.26"	1.00"	1.00"	3/8-24X5/16 (2)
S1006-0500	1/2"	6.00"	1.49"	1.00"	1.00"	1/4-28x1/4 (2)

MORSE TAPER END MILL HOLDERS

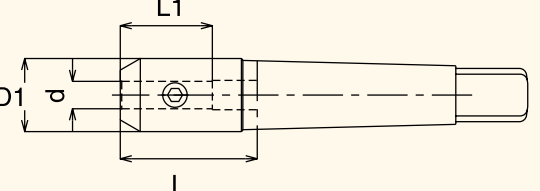
						
Part Number	Taper	d	D1	L	L1	Set Screw
M0206-0125	MT#2	1/8"	1.50"	0.67"	0.75"	6-32X1/4
M0206-0187	MT#2	3/16"	1.50"	0.87"	0.75"	8-32X1/4
M0206-0250	MT#2	1/4"	1.50"	1.07"	0.79"	1/4-28X1/4
M0206-0312	MT#2	5/16"	1.50"	1.26"	0.87"	5/16-24X5/16
M0206-0375	MT#2	3/8"	1.63"	1.26"	1.00"	3/8-24X5/16
M0206-0500	MT#2	1/2"	1.81"	1.53"	1.26"	7/16-20X3/8
M0306-0250	MT#3	1/4"	1.50"	1.07"	0.79"	1/4-28X1/4
M0306-0312	MT#3	5/16"	1.50"	1.26"	0.87"	5/16-24X5/16
M0306-0375	MT#3	3/8"	1.88"	1.26"	1.00"	3/8-24X5/16
M0306-0500	MT#3	1/2"	1.94"	1.50"	1.38"	7/16-20X3/8
M0406-0375	MT#4	3/8"	2.00"	1.35"	1.00"	3/8-24X5/16
M0406-0500	MT#4	1/2"	2.31"	1.46"	1.38"	7/16-20X3/8
M0406-0625	MT#4	5/8"	2.50"	1.61"	1.65"	9/16-18X1/2
M0406-0750	MT#4	3/4"	2.75"	1.77"	1.89"	5/8-18X1/2

Note: End Mill Holders come equipped with set screws.

END MILL HOLDERS

REPLACEMENT EMH SET SCREWS

Part Number	Size of Holder I.D.
S6-32X1/4	1/8"
S8-32X1/4	3/16"
S1-14x7/8	2", 2-1/2"
S1/4-28x1/4	1/4", 6mm
S5/16-24X1/4	5/16", 8mm
S3/8-24X5/16	3/8", 7/16", 10mm
S7/16-20X3/8	1/2", 12mm
S9/16-18X1/2	5/8", 14-16mm
S5/8-18X1/2	3/4", 7/8", 18-20mm
S3/4-16X11/16	1", 1-1/4", 1-1/2", 25-42mm



REPLACEMENT AEROSPACE EMH SET SCREWS

Part Number	Size of Holder I.D.
S3/4-16UNF	1", 1-1/4", 1-1/2", 2", 2-1/2" Aerospace End Mill Holder
S1/2-20UNF	5/8", 3/4", 7/8" Aerospace End Mill Holder
S3/8-24UNF	3/8", 1/2" Aerospace End Mill Holder



Note: End Mill Holders come equipped with set screws.