

BULLS-EYE™ CHUCKS

BULL'S-EYE™ CHUCK

LSK™ COLLET CHUCK

INSIDER™ COLLET CHUCK

ULTRA LOCK™ MILLING





On Target for Zero Run-Out

The Bull's Eye™ Chuck can be easily adjusted to reduce the run-out of the cutting tool to zero at the tip in less than a minute. The adjustability of Lyndex's Bull's Eye™ Chuck produces longer tool life, improved part accuracy and better surface finish.

Bulls-Eye™ Chuck Sizes:

The Bull's-Eye™ Chuck utilizes Lyndex's high accuracy LSK™ collets (see page 12).

- LSK06: 0.7-6mm (0.027-0.236") capacity
- LSK10: 1.75-10mm (0.069-0.393") capacity
- LSK16: 2.75-16mm (0.108-0.629") capacity
- LSK25: 16.0-25.4mm (0.629-1.000") capacity

Adjustment Instructions:

1. Loosen the two Cam Ring Lock Screws and rotate the Cam Screw to the free position. Set the Dial Gage to the front end of the cutting tool.
2. Rotate the tool to establish the position of maximum run-out. Turn the Cam Ring and locate the Cam Screw at the maximum run-out position.
3. Using the supplied hex wrench, turn the Cam Screw until the run-out decreases to the medium value between maximum and minimum.
4. To confirm: rotate the toolholder to check the run-out. If the run-out is not satisfactory, return the Cam Screw to the free position and repeat from step 2. Finally, tighten the two Ring Lock Screws.

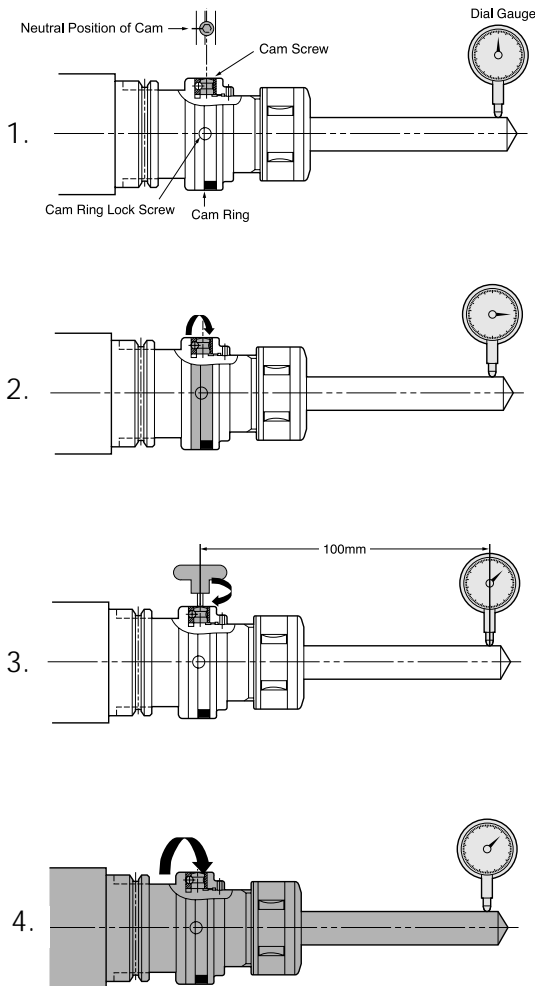

Max. adjustable run-out at 100mm from Cam center	
LSK06	0.050mm
LSK10	0.050mm
LSK16	0.040mm
LSK25	0.025mm

Note: Make sure the adjustment is done within the above range. If this range is exceeded, loosening of the Cam may become difficult.

CT TAPER BULLS-EYE™ HOLDERS

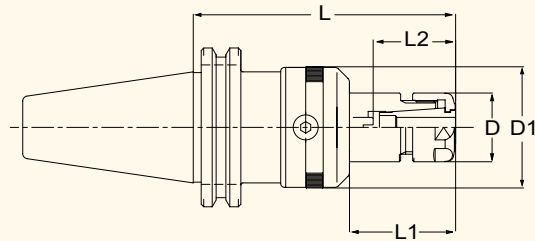

Part Number	Taper	Collet Series	L	L1	L2	D	D1
C40BES-LSK06	CT40	LSK06	3.543"	1.772"	0.827-1.378"	0.768"	1.594"
C40BES-LSK06L	CT40	LSK06	5.906"	3.504"	0.827-1.378"	0.768"	1.594"
C40BES-LSK10	CT40	LSK10	3.543"	1.063"	1.181-1.969"	1.083"	1.909"
C40BES-LSK10L	CT40	LSK10	4.724"	2.244"	1.181-1.969"	1.083"	1.909"
C40BES-LSK10EL	CT40	LSK10	5.906"	3.425"	1.181-1.969"	1.083"	1.909"
C40BES-LSK16	CT40	LSK16	3.543"	0.827"	1.772-2.756"	1.575"	2.343"
C40BES-LSK16L	CT40	LSK16	4.724"	2.008"	1.772-2.756"	1.575"	2.343"
C40BES-LSK16EL	CT40	LSK16	5.906"	3.189"	1.772-2.756"	1.575"	2.343"
C40BES-LSK25	CT40	LSK25	4.724"	1.929"	2.165-3.346"	2.165"	2.618"
C40BES-LSK25L	CT40	LSK25	5.906"	3.110"	2.165-3.346"	2.165"	2.618"
C50BES-LSK06	CT50	LSK06	4.134"	2.362"	0.827-1.378"	0.768"	1.594"
C50BES-LSK06L	CT50	LSK06	6.496"	2.638"	0.827-1.378"	0.768"	1.594"
C50BES-LSK10	CT50	LSK10	4.134"	2.362"	1.181-1.969"	1.083"	1.909"
C50BES-LSK10L	CT50	LSK10	6.496"	2.559"	1.181-1.969"	1.083"	1.909"
C50BES-LSK16	CT50	LSK16	4.134"	2.362"	1.772-2.756"	1.575"	2.343"
C50BES-LSK16L	CT50	LSK16	6.496"	4.724"	1.772-2.756"	1.575"	2.343"
C50BES-LSK25	CT50	LSK25	4.724"	2.953"	2.165-3.346"	2.165"	2.618"
C50BES-LSK25L	CT50	LSK25	6.496"	4.724"	2.165-3.346"	2.165"	2.618"

COLLET RANGE

Collet Series	Range	Nut Tightening Torque
LSK06	0.7-6mm (0.027-0.236")	22.1 – 29.4 ft-lbs (7.3 ft-lbs for γ [3mm])
LSK10	1.75-10mm (0.069-0.393")	33.2 – 44.2 ft-lbs
LSK16	2.75-16mm (0.108-0.629")	55.3 – 62.6 ft-lbs
LSK25	16.0-25.4mm (0.629-1.000")	66.3 – 72.9 ft-lbs

BT TAPER BULLS-EYE™ HOLDERS

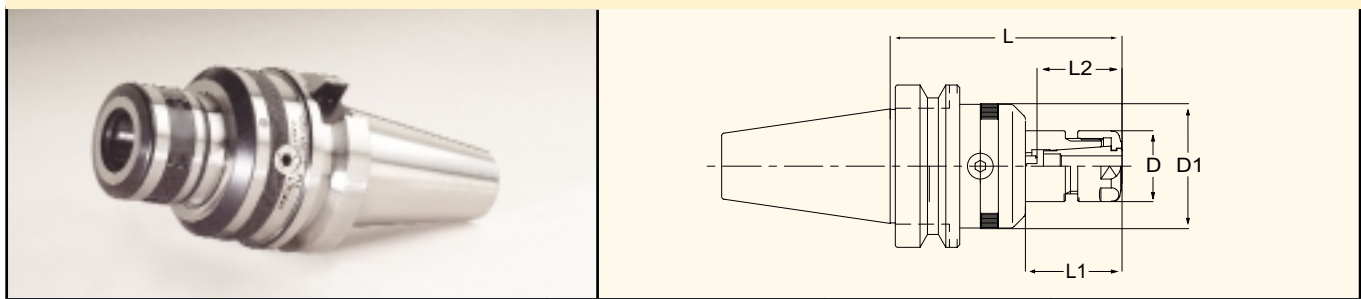

Part Number	Taper	Collet Series	L	L1	L2	D	D1
B30BES-LSK06	BT30	LSK06	3.543"	1.654"	0.827-1.378"	0.768"	1.594"
B30BES-LSK10	BT30	LSK10	3.543"	1.378"	1.181-1.969"	1.083"	1.909"
B30BES-LSK16	BT30	LSK16	4.134"	1.575"	1.772-2.559"	1.575"	2.343"
B40BES-LSK06	BT40	LSK06	3.543"	1.457"	0.827-1.378"	0.768"	1.594"
B40BES-LSK06L	BT40	LSK06	5.906"	2.362"	0.827-1.378"	0.768"	1.594"
B40BES-LSK10	BT40	LSK10	3.543"	1.457"	1.181-1.969"	1.083"	1.909"
B40BES-LSK10L	BT40	LSK10	4.724"	2.638"	1.181-1.969"	1.083"	1.909"
B40BES-LSK10EL	BT40	LSK10	5.906"	3.819"	1.181-1.969"	1.083"	1.909"
B40BES-LSK16	BT40	LSK16	3.543"	1.457"	1.772-2.756"	1.575"	2.343"
B40BES-LSK16L	BT40	LSK16	4.724"	2.638"	1.772-2.756"	1.575"	2.343"
B40BES-LSK16EL	BT40	LSK16	5.906"	3.819"	1.772-2.756"	1.575"	2.343"
B40BES-LSK25	BT40	LSK25	4.724"	2.165"	2.165-3.346"	2.165"	2.618"
B40BES-LSK25L	BT40	LSK25	5.906"	3.386"	2.165-3.346"	2.165"	2.618"
B50BES-LSK06	BT50	LSK06	4.134"	1.614"	0.827-1.378"	0.768"	1.594"
B50BES-LSK06L	BT50	LSK06	6.496"	2.480"	0.827-1.378"	0.768"	1.594"
B50BES-LSK10	BT50	LSK10	4.134"	1.614"	1.181-1.969"	1.083"	1.909"
B50BES-LSK10L	BT50	LSK10	6.496"	3.976"	1.181-1.969"	1.083"	1.909"
B50BES-LSK16	BT50	LSK16	4.134"	1.614"	1.772-2.756"	1.575"	2.343"
B50BES-LSK16L	BT50	LSK16	6.496"	3.976"	1.772-2.756"	1.575"	2.343"
B50BES-LSK25	BT50	LSK25	5.315"	2.795"	2.165-3.346"	2.165"	2.618"
B50BES-LSK25L	BT50	LSK25	6.496"	3.976"	2.165-3.346"	2.165"	2.618"

COLLET RANGE

Collet Series	Range	Nut Tightening Torque
LSK06	0.7-6mm (0.027-0.236")	22.1 – 29.4 ft-lbs (7.3 ft-lbs for γ [3mm])
LSK10	1.75-10mm (0.069-0.393")	33.2 – 44.2 ft-lbs
LSK16	2.75-16mm (0.108-0.629")	55.3 – 62.6 ft-lbs
LSK25	16.0-25.4mm (0.629-1.000")	66.3 – 72.9 ft-lbs

HSK TAPER BULLS-EYE™ HOLDERS

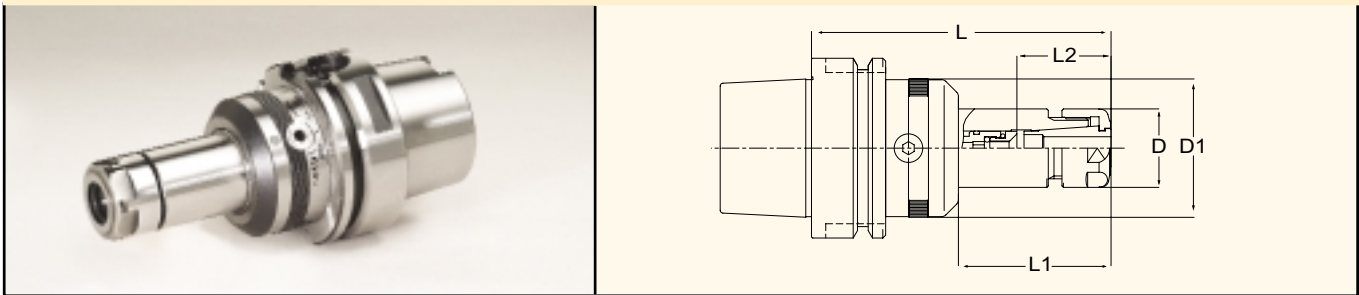

Part Number	Taper	Collet Series	L	L1	L2	D	D1
HSK63A-BES06-120	HSK63A	LSK06	4.724"	2.677"	1.024-1.220"	0.768"	1.594"
HSK63A-BES10-105	HSK63A	LSK10	4.134"	2.087"	1.378-1.614"	1.083"	1.909"
HSK63A-BES10-150	HSK63A	LSK10	5.906"	3.858"	1.378-1.614"	1.083"	1.909"
HSK63A-BES16-150	HSK63A	LSK16	5.906"	2.992"	1.772-2.244"	1.575"	2.343"
HSK63A-BES25-135	HSK63A	LSK25	5.315"	2.244"	2.362-2.756"	2.165"	2.618"
HSK100A-BES06-120	HSK100A	LSK06	4.724"	2.559"	1.024-1.220"	0.768"	1.594"
HSK100A-BES10-150	HSK100A	LSK10	5.906"	3.740"	1.378-1.614"	1.083"	1.909"
HSK100A-BES16-150	HSK100A	LSK16	5.906"	3.740"	1.772-2.244"	1.575"	2.343"
HSK100A-BES25-150	HSK100A	LSK25	5.906"	3.740"	2.362-2.756"	2.165"	2.618"

COLLET RANGE

Collet Series	Range	Nut Tightening Torque
LSK06	0.7-6mm (0.027-0.236")	22.1 – 29.4 ft-lbs (7.3 ft-lbs for y [3mm])
LSK10	1.75-10mm (0.069-0.393")	33.2 – 44.2 ft-lbs
LSK16	2.75-16mm (0.108-0.629")	55.3 – 62.6 ft-lbs
LSK25	16.0-25.4mm (0.629-1.000")	66.3 – 72.9 ft-lbs